

**REQUEST FOR PROPOSAL  
2024 FEDERAL AID HMA OVERLAY DESIGN  
TUSCOLA COUNTY  
BOARD OF COUNTY ROAD COMMISSIONERS  
1733 S. MERTZ RD.  
CARO, MI 48723**

**COMPANY:** \_\_\_\_\_

**ADDRESS:** \_\_\_\_\_  
\_\_\_\_\_

**SIGN & PRINT:** \_\_\_\_\_

**DATE:** \_\_\_\_\_

**PHONE & FAX:** \_\_\_\_\_

**EMAIL:** \_\_\_\_\_

**Federal Aid HMA Overlay Design:  
Completed Proposal and Plans to MDOT for January 2024 Bid Letting**

- 1. Hurds Corner Road – M-46 to Bevens Road (3.04 miles)**  
Wells Township, Sections 21, 22, 27, 28, 33, 34  
Application Estimate: \$381,100
  
- 2. Hurds Corner Road – Bevens Road to Deckerville Road (3.96 miles)**  
Ellington Township, Sections 33, 34  
Wells Township, Sections 3, 4, 9, 10, 15, 16  
Application Estimate: \$456,400

**Cost for Design Package:        \$ \_\_\_\_\_**

*Qualification statements/quote proposals shall be received no later than 9:15 AM Thursday September 15, 2022, to Brent Dankert P.E., Acting County Highway Engineer. Late proposals will not be considered. See notice to bidder. Proposals must be delivered in a plainly marked and seal envelope. No electronic bids will be accepted.*

## **REQUEST FOR PROPOSAL 2024 FEDERAL AID HMA OVERLAY DESIGN**

### **Proposal Intent**

The Tuscola County Road Commission seeks to hire a qualified, professional engineering team to provide survey & design services, any necessary environmental permitting, and preparation of plans, specifications, and preliminary estimates of cost for the HMA Overlay and Signage Updates for Hurds Corner Road from M-46 to Bevens Road (3.04 miles of 1.5" HMA resurfacing) and Hurds Corner Road from Bevens Road to Deckerville Road (3.96 miles of 1.5" HMA resurfacing). The TCRC expects consultants proposing on this project to have the qualifications, experience, personnel, and overall understanding of the work. The consultant shall have the following MDOT Prequalification - Design Roadway.

### **Background**

The Tuscola County Road Commission has the Hurds Corner Road from M-46 to Bevens Road and Bevens Road to Deckerville Road HMA Resurfacing project on the 2024 Rural Task Force 7A Federal and State Program. For Hurds Corner Road from M-46 to Bevens Road the Federal STP is listed at \$304,880 with a local contribution of \$76,220, for a total project estimate of \$381,100.

For Hurds Corner Road from Bevens Road to Deckerville Road the Federal HIP is listed at \$35,186, State D funding is listed at \$329,934, with a local contribution of \$91,280 for a total project estimate of \$456,400.

Included in the project is approximately 7.0 miles of 1.5" HMA overlay, shoulder aggregate, approaches, pavement markings, and permanent signage upgrades. It is anticipated this will be a log project.

The intent is to include the project with MDOT's January 2024 bid letting. The design and permitting of the project needs to be completed in accordance with the *Local Agency Programs FY 2024 Project Planning Guide* and in accordance with all MDOT Local Agency Design Standards and policies.

### **Proposal Submittal**

The Tuscola County Road Commission (TCRC) is soliciting qualification statements and quote proposals to perform design services for the culverts discussed above. The proposal shall contain, at a minimum, the following items:

- Qualifications for all team members Involved.
- An understanding of the requested design services.
- Design fee and breakdown
  - Include an hourly fee schedule with the proposal.
- The proposed design must follow all Federal, State and local design standards and guidelines and include the following:
  - A final plan set with all necessary special provisions associated to the construction of the proposed design

# REQUEST FOR PROPOSAL 2024 FEDERAL AID HMA OVERLAY DESIGN

## Scoring

The scoring of the submitted proposal will be based on the following criteria:

30%	Understanding of Services
30%	Qualifications of Team
20%	Design Fee
15%	Past Performance
5%	Location

## Award and Payment

Award will be made in the best interest of the Road Commission. Payment will be made by monthly invoicing. Please limit your package to maximum of five (5) pages and submit your company's hourly fee schedule with the proposal. The completed first page of the RFP does not count toward the 5-page maximum. Any questions should be made to Brent Dankert at [highwayengineer@tuscolaroad.org](mailto:highwayengineer@tuscolaroad.org) or 989-751-3873.

## Attachments

- Rural Task Force Data Sheets (MDOT 1799)
- Act 51 Certification maps

## LIABILITY

The consultant shall always exercise extreme care and shall assume all liability for any damages resulting from their operation. Furthermore, they shall hold the Tuscola County Road Commission harmless from any such claims or damages.

## NON-COMPLIANCE WITH PROJECT SPECIFICATION PROVISIONS

Any variation from the specifications of the project herein without written approval from the Tuscola County Road Commission and/or its authorized representative may result in, at the discretion of the Tuscola County Road Commission, the voiding and/or canceling of the acceptance of any contract, resulting from this project.

**The Tuscola County Board of Road Commissioners reserves the right to accept or reject any or all proposals and to re-advertise or to accept the proposal, that in their opinion, is in the best interest of Tuscola County.**

# RURAL TASK FORCE DATA SHEET ROAD JOB

(To be completed by each county or city for every job submitted to the Task Force)

## ALL ITEMS MUST BE COMPLETED

### JOB REQUEST

NEW JOB  OR JOB CHANGE

JOB NUMBER

#### CHANGE TYPE

FY  COST  SCOPE  
 DELETE  MOVE TO ILLUSTRATIVE

FISCAL YEAR  
2024

COUNTY  
Tuscola

CITY / VILLAGE (If applicable)

### ROAD JOB DESCRIPTION

ROAD NAME FROM NFC MAP (<http://mcgi.state.mi.us/nfc>)

NFC FUNCTIONAL CLASSIFICATION

LENGTH (Miles)

Hurds Corner

5 MAJOR Collector

3.96

FROM

TO

Bevens

Deckerville

PHYSICAL REFERENCE (PR) NUMBER: 0269804 BEGINNING MILE: 9.03 ENDING MILE: 12.98 OR MAP ATTACHED:

CONTRACT PROCESS: MDOT Let

CONTRACT TYPE: Design-Bid-Build

#### ALL SEASON ROAD STATUS

PROPOSED ALL SEASON  ALL SEASON NETWORK  N/A (NO STATE "D" FUNDING ON JOB)

<https://mdot.maps.arcgis.com/apps/webappviewer/index.html?id=ac067829f74e49eba28b33605ccd87c0>

ANTICIPATED LETTING DATE (Month/Year)

January 2024

ELEMENTS NEEDING COMMITTEE APPROVAL

GRAVEL ROAD  SIDEWALK  N/A

MAJOR WORK TYPE: One Course Asphalt Overlay (GPA)

#### JOB BUDGET CONSTRUCTION PHASE ONLY: (Not to include ROW, feasibility studies, design, or testing.)

#### ADDITIONAL JOB INFORMATION

1) STP	\$	
2) STP CE (RTF 1 ONLY)	\$	
3) LOCAL MATCH	\$	91,280.00
4) ACC FY	\$	
5) TOTAL PARTICIPATING STP BUDGET (Line 1-4)	\$	<b>91,280.00</b>
6) TEDF "D" AMOUNT:	\$	329,934.00
7) OTHER PARTICIPATING AMOUNT: (CMAQ, BRIDGE, EARMARKS)	\$	35,186.00
8) NON-LAP PARTICIPATING		
a) CE	\$	
b) PE	\$	
c) Other	\$	
9) NON-PARTICIPATING AMOUNT: GRANTS, LOCAL UTILITIES, ETC.	\$	
<b>TOTAL JOB COST:</b>	\$	<b>456,400.00</b>
<b>JOB COST INCLUDING NON-LAP:</b>	\$	<b>456,400.00</b>

3.96 miles of 1.5" HMA overlay. Item #7 for the Job Budget is a Federal HIP Fund.

By checking this box, the person completing this form certifies that the job identified in this document is eligible to be funded with federal Surface Transportation Program (STP) or state Transportation Economic Development Fund Category D funds.

SUBMITTED BY (Please print)

Brent Dankert

TITLE

County Highway Engineer

DATE

02/02/22

SIGNATURE

  
Brent J. Dankert, P.E.

Brent J. Dankert, P.E.  
Feb 4 2022 2:25 PM

PHONE NUMBER

(989) 751-3873

## Engineer's Opinion of Costs

<b>Project Number:</b> 2021-011 <b>Estimate Number:</b> 1: HMA Overlay <b>Project Type:</b> Miscellaneous <b>Location:</b> Hurds Corner Rd Bevens Rd to Deckerville Rd <b>Description:</b> 3.96 miles of 1.5" HMA overlay	<b>Project Engineer:</b> Brent Dankert <b>Date Created:</b> 12/1/2021 <b>Date Edited:</b> 2/4/2022 <b>Fed/State #:</b> <b>Fed Item:</b> <b>Control Section:</b>
--	--

Line	Pay Item	Description	Quantity	Units	Unit Price	Total
0001	1500001	Mobilization, Max	1.000	LSUM	\$39,342.00	\$39,342.00
0002	3070121	Shoulder, CI II	1,300.000	Ton	\$22.00	\$28,600.00
0003	3077031	_ Approach, Class II, Modified	40.000	Ton	\$33.00	\$1,320.00
0004	5010033	HMA, 13A	4,300.000	Ton	\$71.00	\$305,300.00
0005	5010061	HMA Approach	160.000	Ton	\$140.00	\$22,400.00
0006	8070095	Post, Mailbox	1.000	Ea	\$100.00	\$100.00
0007	8100371	Post, Steel, 3 lb	525.000	Ft	\$6.00	\$3,150.00
0008	8100398	Sign, Type IIA	42.000	Sft	\$20.00	\$840.00
0009	8100403	Sign, Type III, Rem	33.000	Ea	\$10.00	\$330.00
0010	8100404	Sign, Type IIIA	108.000	Sft	\$20.00	\$2,160.00
0011	8100405	Sign, Type IIIB	56.000	Sft	\$16.00	\$896.00
0012	8100616	Reflective Panel for Permanent Sign Support, 6 foot	25.000	Ea	\$30.00	\$750.00
0013	8110231	Pavt Mrkg, Waterborne, 4 inch, White	41,818.000	Ft	\$0.07	\$2,927.26
0014	8110232	Pavt Mrkg, Waterborne, 4 inch, Yellow	5,167.000	Ft	\$0.07	\$361.69
0015	8120035	Channelizing Device, 42 inch, Fluorescent, Furn	100.000	Ea	\$15.00	\$1,500.00

Line	Pay Item	Description	Quantity	Units	Unit Price	Total
0016	8120036	Channelizing Device, 42 inch, Fluorescent, Oper	100.000	Ea	\$1.00	\$100.00
0017	8120140	Lighted Arrow, Type C, Furn	2.000	Ea	\$500.00	\$1,000.00
0018	8120141	Lighted Arrow, Type C, Oper	2.000	Ea	\$100.00	\$200.00
0019	8120170	Minor Traf Devices	1.000	LSUM	\$15,737.00	\$15,737.00
0020	8120231	Pavt Mrkg, Type NR, Tape, 4 inch, Yellow, Temp	1,500.000	Ft	\$1.00	\$1,500.00
0021	8120350	Sign, Type B, Temp, Prismatic, Furn	288.000	Sft	\$3.61	\$1,039.68
0022	8120351	Sign, Type B, Temp, Prismatic, Oper	288.000	Sft	\$0.75	\$216.00
0023	8120370	Traf Regulator Control	1.000	LSUM	\$7,868.00	\$7,868.00
0024	8210005	Monument Box Adjust	7.000	Ea	\$600.00	\$4,200.00
0025	8507011	_ Slope Restoration	4,645.000	Syd	\$3.00	\$13,935.00

**Estimate Total: \$455,772.63**

\$456,000  
20% = 91,200  
80% = \$364,800

# RURAL TASK FORCE DATA SHEET ROAD JOB

(To be completed by each county or city for every job submitted to the Task Force)

## ALL ITEMS MUST BE COMPLETED

### JOB REQUEST

NEW JOB <input type="checkbox"/>	OR	JOB CHANGE <input checked="" type="checkbox"/>	JOB NUMBER	CHANGE TYPE <input type="checkbox"/> FY <input checked="" type="checkbox"/> COST <input type="checkbox"/> SCOPE <input type="checkbox"/> DELETE <input type="checkbox"/> MOVE TO ILLUSTRATIVE
FISCAL YEAR 2024	COUNTY Tuscola	CITY / VILLAGE (If applicable)		

### ROAD JOB DESCRIPTION

ROAD NAME FROM NFC MAP ( <a href="http://mcgi.state.mi.us/nfc">http://mcgi.state.mi.us/nfc</a> ) Hurds Corner	NFC FUNCTIONAL CLASSIFICATION 5 MAJOR Collector	LENGTH (Miles) 3.04
FROM M-46	TO Bevens	
PHYSICAL REFERENCE (PR) NUMBER: 269804	BEGINNING MILE: 6.011	ENDING MILE: 9.034 <b>OR</b> MAP ATTACHED: <input type="checkbox"/>

CONTRACT PROCESS: MDOT Let	CONTRACT TYPE: Design-Bid-Build
----------------------------	---------------------------------

ALL SEASON ROAD STATUS <input type="checkbox"/> PROPOSED ALL SEASON <input checked="" type="checkbox"/> ALL SEASON NETWORK <input type="checkbox"/> N/A (NO STATE "D" FUNDING ON JOB)	<a href="https://mdot.maps.arcgis.com/apps/webappviewer/index.html?id=ac067829f74e49eba28b33605ccd87c0">https://mdot.maps.arcgis.com/apps/webappviewer/index.html?id=ac067829f74e49eba28b33605ccd87c0</a>
--	---

ANTICIPATED LETTING DATE (Month/Year) January 2024	ELEMENTS NEEDING COMMITTEE APPROVAL <input type="checkbox"/> GRAVEL ROAD <input type="checkbox"/> SIDEWALK <input checked="" type="checkbox"/> N/A
---	---

MAJOR WORK TYPE: One Course Asphalt Overlay (GPA)

JOB BUDGET CONSTRUCTION PHASE ONLY: (Not to include ROW, feasibility studies, design, or testing.)	ADDITIONAL JOB INFORMATION
1) STP \$ 304,880.00	3.04 miles of 1.5" HMA overlay
2) STP CE (RTF 1 ONLY) \$	
3) LOCAL MATCH \$ 76,223.00	
4) ACC FY \$	
5) TOTAL PARTICIPATING STP BUDGET (Line 1-4) \$ 381,103.00	
6) TEDF "D" AMOUNT: \$	
7) OTHER PARTICIPATING AMOUNT: (CMAQ, BRIDGE, EARMARKS) \$	
8) NON-LAP PARTICIPATING	
a) CE \$	
b) PE \$	
c) Other \$	
9) NON-PARTICIPATING AMOUNT: GRANTS, LOCAL UTILITIES, ETC. \$	
<b>TOTAL JOB COST: \$ 381,103.00</b>	
<b>JOB COST INCLUDING NON-LAP: \$ 381,103.00</b>	

By checking this box, the person completing this form certifies that the job identified in this document is eligible to be funded with federal Surface Transportation Program (STP) or state Transportation Economic Development Fund Category D funds.

SUBMITTED BY (Please print) Brent Dankert	TITLE County Highway Engineer	DATE 02/02/22
SIGNATURE  Brent J. Dankert, P.E.	Brent J. Dankert, P.E. Feb 4 2022 2:26 PM	PHONE NUMBER (989) 751-3873

## Engineer's Opinion of Costs

**Project Number:** 2018-07  
**Estimate Number:** 1: Overlay 1.5"  
**Project Type:** Road Rehabilitation  
**Location:** Hurds Corner  
 M-46 to Bevens  
**Description:** 3.04 miles of 1.5" HMA overlay

**Project Engineer:** Brent Dankert  
**Date Created:** 11/5/2018  
**Date Edited:** 12/1/2021  
**Fed/State #:**  
**Fed Item:**  
**Control Section:**

Line	Pay Item	Description	Quantity	Units	Unit Price	Total
<b>Category: 0000</b>						
0001	1500001	Mobilization, Max	1.000	LSUM	\$32,204.00	\$32,204.00
0002	3070021	Approach, CI II	370.000	Ton	\$21.94	\$8,117.80
0003	3070121	Shoulder, CI II	1,000.000	Ton	\$21.30	\$21,300.00
0004	3077031	_ Approach, CI II, Modified	60.000	Ton	\$33.00	\$1,980.00
0005	5010033	HMA, 13A	3,777.000	Ton	\$70.00	\$264,390.00
0006	5010061	HMA Approach	30.000	Ton	\$140.00	\$4,200.00
0007	8100371	Post, Steel, 3 lb	495.000	Ft	\$6.00	\$2,970.00
0008	8100398	Sign, Type IIA	32.000	Sft	\$20.00	\$640.00
0009	8100403	Sign, Type III, Rem	31.000	Ea	\$10.00	\$310.00
0010	8100404	Sign, Type IIIA	72.000	Sft	\$20.00	\$1,440.00
0011	8100405	Sign, Type IIIB	135.000	Sft	\$16.00	\$2,160.00
0012	8100616	Reflective Panel for Permanent Sign Support, 6 foot	25.000	Ea	\$30.00	\$750.00
0013	8110231	Pavt Mrkg, Waterborne, 4 inch, White	32,208.000	Ft	\$0.07	\$2,254.56
0014	8110232	Pavt Mrkg, Waterborne, 4 inch, Yellow	10,295.000	Ft	\$0.07	\$720.65
0015	8120030	Channelizing Device, 42 inch, Furn	100.000	Ea	\$15.00	\$1,500.00
0016	8120031	Channelizing Device, 42 inch, Oper	100.000	Ea	\$1.00	\$100.00
0017	8120140	Lighted Arrow, Type C, Furn	2.000	Ea	\$500.00	\$1,000.00
0018	8120141	Lighted Arrow, Type C, Oper	2.000	Ea	\$100.00	\$200.00
0019	8120170	Minor Traf Devices	1.000	LSUM	\$12,881.00	\$12,881.00
0020	8120350	Sign, Type B, Temp, Prismatic, Furn	288.000	Sft	\$3.61	\$1,039.68
0021	8120351	Sign, Type B, Temp, Prismatic, Oper	288.000	Sft	\$0.75	\$216.00
0022	8120370	Traf Regulator Control	1.000	LSUM	\$6,441.00	\$6,441.00



Line	Pay Item	Description	Quantity	Units	Unit Price	Total
0023	8210005	Monument Box Adjust	6.000	Ea	\$600.00	\$3,600.00
0024	8507011	_ Slope Restoration	3,567.000	Syd	\$3.00	\$10,701.00

**Category 0000 Total: \$381,115.69**

**Estimate Total: \$381,115.69**

\$381,100  
 20% = \$304,880  
 80% = \$76,220

TOWNSHIP OF  
**ELLINGTON**  
 TUSCOLA COUNTY  
 T 13 N - R 10 E  
 ROAD SYSTEMS  
 ACT 51 PUBLIC ACTS 1961

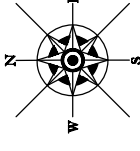

PREPARED BY  
**MICHIGAN**

DEPARTMENT OF TRANSPORTATION

SCALE



PRIMARY ROAD SYSTEM 19.49 MILES  
 LOCAL ROAD SYSTEM 48.12 MILES

**LEGEND**

- COUNTY LINE
- CORPORATE LIMITS
- TOWNSHIP LINE
- STATE TRUNK LINE
- COUNTY PRIMARY
- COUNTY LOCAL
- CITY OR VILLAGE MAJOR STREET
- ADJOINING COUNTY
- ADJOINING TOWNSHIP

1	2	3	4	5	6
7	8	9	10	11	
12	13	14	15	16	
17	18	19	20	21	
22	23	24			

KEY TO TWP. SHEET NUMBERS

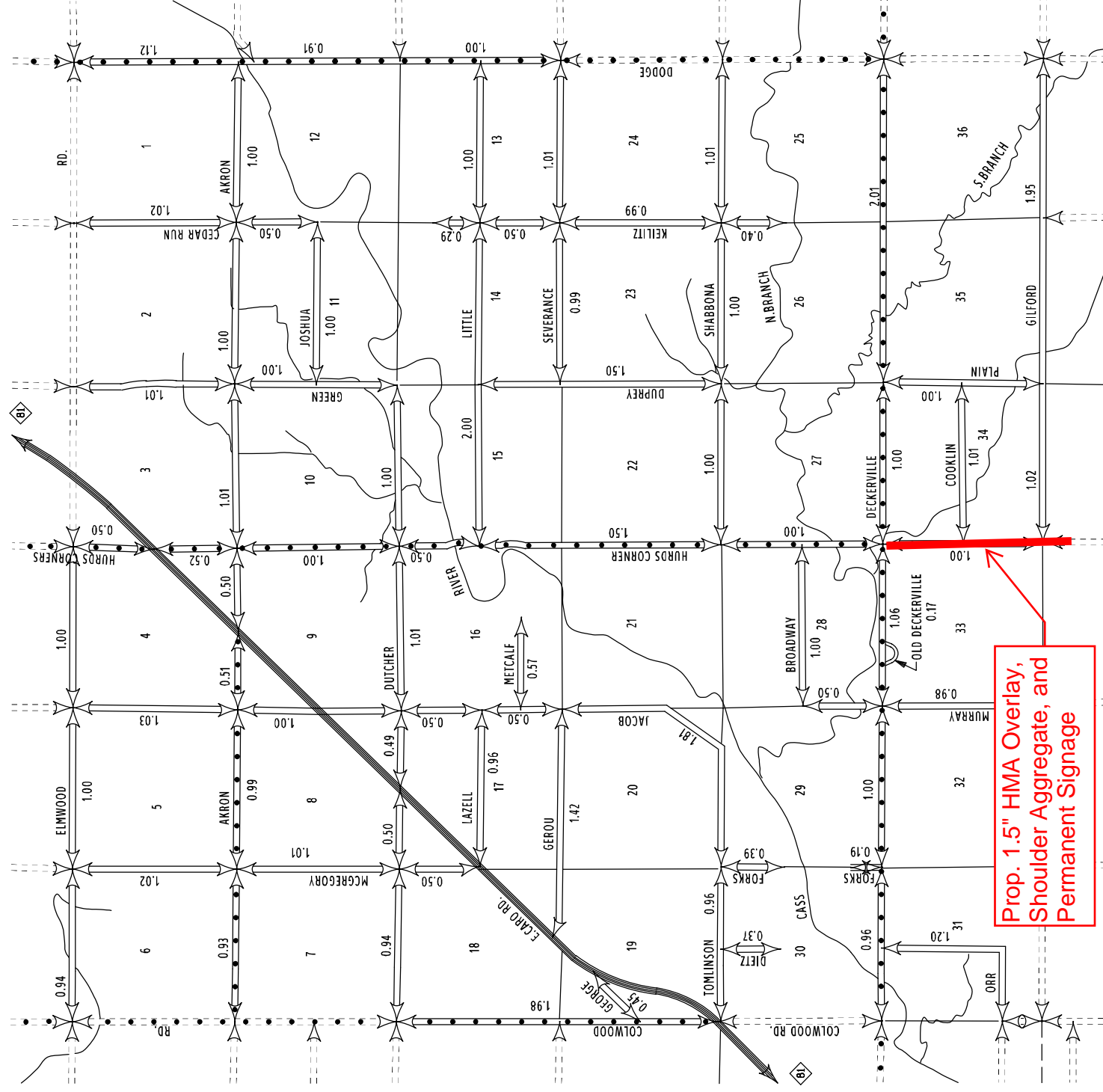

TOWNSHIP OF  
**WELLS**  
 TUSCOLA COUNTY  
 T 12 N - R 10 E  
**ROAD SYSTEMS**  
 ACT 51 PUBLIC ACTS 1961

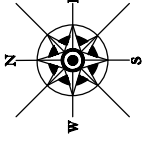

PREPARED BY  
**MICHIGAN**

DEPARTMENT OF TRANSPORTATION

SCALE



PRIMARY ROAD SYSTEM 16.69 MILES  
 LOCAL ROAD SYSTEM 61.17 MILES

**LEGEND**

COUNTY LINE	---	1	4	5	6	
CORPORATE LIMITS	---	2	3	4	5	6
TOWNSHIP LINE	---	7	8	9	10	11
STATE TRUNK LINE	---	12	13	14	15	16
COUNTY PRIMARY	---	17	18	19	20	21
COUNTY LOCAL	---	22	23	24		
CITY OR VILLAGE MAJOR STREET	---					
ADJOINING COUNTY	+++++					
ADJOINING TOWNSHIP	-----					

KEY TO TWP. SHEET NUMBERS

